

Visit Pushbutton Transmitter

BE1420-868

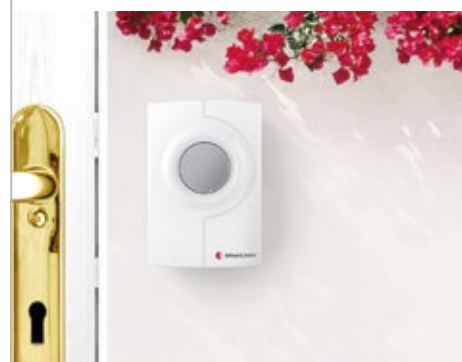

Features

Easily accessible

Wear it around the neck 24/7

Lightweight and durable

Withstands everyday use

Reliable transmission

Up to 250 m operating range

Long lasting power

~ 2 years of battery life

MD

CE-marked medical device
under EU MDR 2017/745

Your home at your fingertips.

The Pushbutton Transmitter from Bellman & Symfon is part of the Visit system that helps you to keep tabs on your home. It can either be worn around your neck as a portable caller button, or installed by the front door as a wireless doorbell.

Lightweight and durable

The transmitter is designed to withstand everyday use, virtually maintenance free and operates for years on a single battery.

Using it as a caller button

Ask your spouse to wear the transmitter around the neck so that you are always available if something happens that requires your attention.

When your dear one pushes the button to call for assistance, the signal is immediately forwarded to your Visit receiver that alerts you with sound, flashes or vibrations (depending on the receiver).

Using it as a doorbell

The Pushbutton Transmitter can also be used as a wireless doorbell. Just set it up by the front door like a regular doorbell to keep track of the comings and goings in your home.

When the guests arrive and pushes the button, the signal is relayed to your Visit receiver that alerts you with sound, flashes or vibrations (depending on the receiver).

Technical specifications

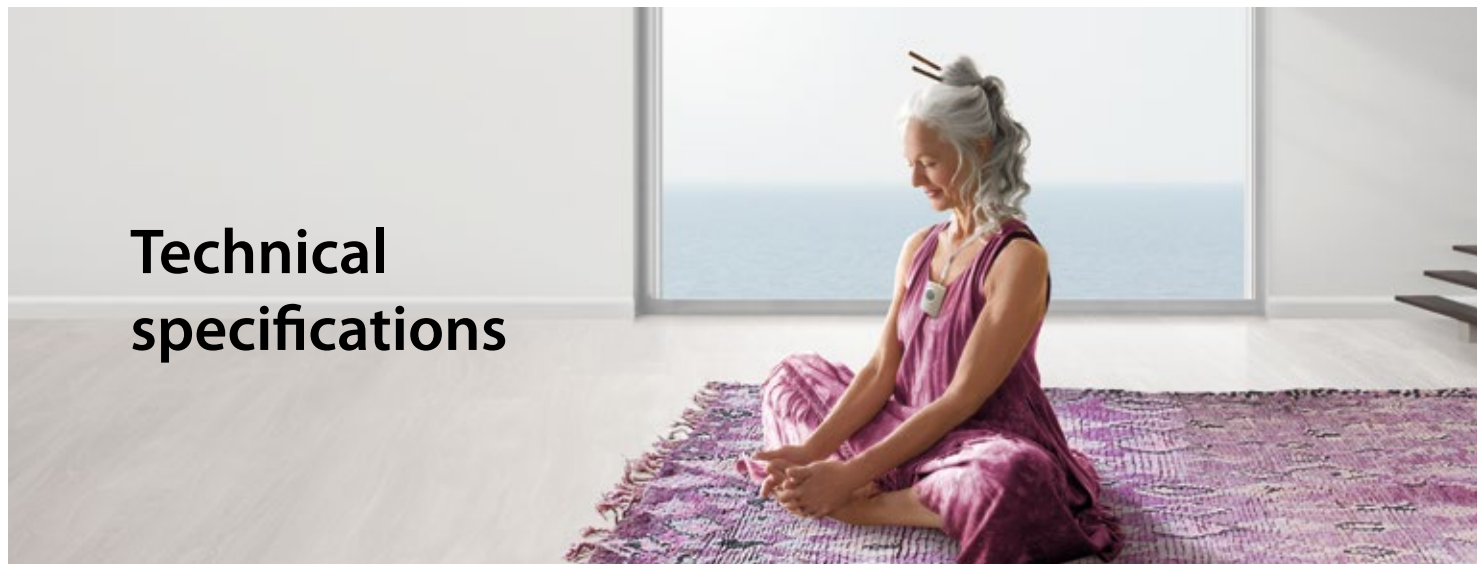

Dimensions and weight

Height: **66 mm, 2.6"**
Width: **48 mm, 1.9"**
Depth: **23 mm, 0.9"**
Weight: **50 g, 1.8 oz. incl. batteries**



Product overview

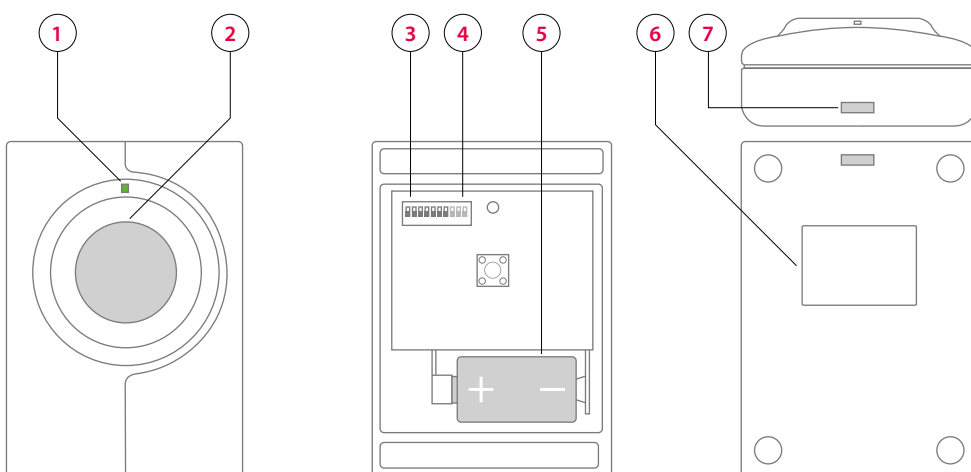

Power and battery

- Battery type
6V PX28A Alkaline or 6V PX28L Lithium
- Power consumption
Active 35 mA, idle position 0.05 μ A
- Operation time
Alkaline ~ 2 years, Lithium ~ 4 years

Number of radio keys

- 64 as standard. Up to 256 with optional software.

Frequency and coverage

- Radio frequency: 868.3 MHz
- Coverage: 50 – 250 m (55 – 273 yd)
Depending on the radio frequency, building's characteristics and the combination of transmitters and receivers.

Approvals



This product is a medical device in conformity with Regulation (EU) 2017/745 (Medical Device Regulation).

Buttons and controls

- 1 Status LED
- 2 Pushbutton
- 3 Signal switch
- 4 Radio key switch
- 5 Battery compartment
- 6 Hole for lanyard
- 7 Adhesive tape for wall mounting

Maintenance and cleaning

- Maintenance free. Clean with a dry cloth.
- Do not use household cleaners, aerosol sprays, solvents, alcohol, ammonia, or abrasives.
- Not reusable.

Environmental requirements

- For indoor use and outdoor use in a protected location. Will not withstand water or rain. (IP42)
- Temperature: -10° to 40° C, 14° to 104° F
- Relative humidity: 15% -90%, non-condensing

In the box

- BE1420-868 Visit Pushbutton Transmitter
- PX28A 6V Alkaline battery
- Lanyard with safety clasp
- Screws and plugs
- Double-sided adhesive tape
- User manual



© 2025 Bellman & Symfon AB. All rights reserved.

Bellman, Bellman & Symfon and the Bellman & Symfon logo are registered trademarks of Bellman & Symfon AB. This leaflet is subject to change without prior notice.

BE1420-868_001DSH1.0-EN

bellman.com